

TYPICAL FLAT SLAB-TRANSVERSE SECTION

NO. SCALE

SLAB NOTES:

1. TYPICAL FLAT SLAB TO BE 5" THICK.
2. FOR SLAB REIN. SEE REINFORCING PLANS & TYP. SLAB SECTIONS.
3. MAXIMUM SPACING OF BOTTOM LONGITUDINAL REIN. SHALL BE 12" O.C. IN THE TRANS. DIRECTION & TO BE 12" O.C. IN THE LONG. DIRECTION. (THIS REIN. NOT SHOWN ON REINFORCING PLANS) ALL BOTTOM STEEL SHOWN ON PLANS ARE CUT.
4. TYPICAL BOTTOM STEEL SLAB STRIPS BETWEEN 5" O.C. OF COLUMN STRIP.
5. 1/2" O.C. OF COLUMN STRIP.
6. OUTER MOST LAYER.
7. PROVIDE SUPPORT.
8. ALL SLAB REIN. TO BE 1/2" O.C. IN THE TRANS. DIRECTION.
9. OPENINGS IN FLAT SLAB TO BE 12" O.C. IN THE TRANS. DIRECTION & TO BE 12" O.C. IN THE LONG. DIRECTION. (THIS REIN. NOT SHOWN ON REINFORCING PLANS) ALL BOTTOM STEEL SHOWN ON PLANS ARE CUT.
10. ALL MECHANICAL SLABS TO BE SPACED SO AS TO BE 1/2" O.C. BETWEEN SLAB.

REIN. STRIPS: REIN. STRIPS TO BE CUT & REPLACED WITH ADDITIONAL STEEL OF SAME SIZE & TO BE 12" O.C. IN THE TRANS. DIRECTION & TO BE 12" O.C. IN THE LONG. DIRECTION. (THIS REIN. NOT SHOWN ON REINFORCING PLANS) ALL BOTTOM STEEL SHOWN ON PLANS ARE CUT.

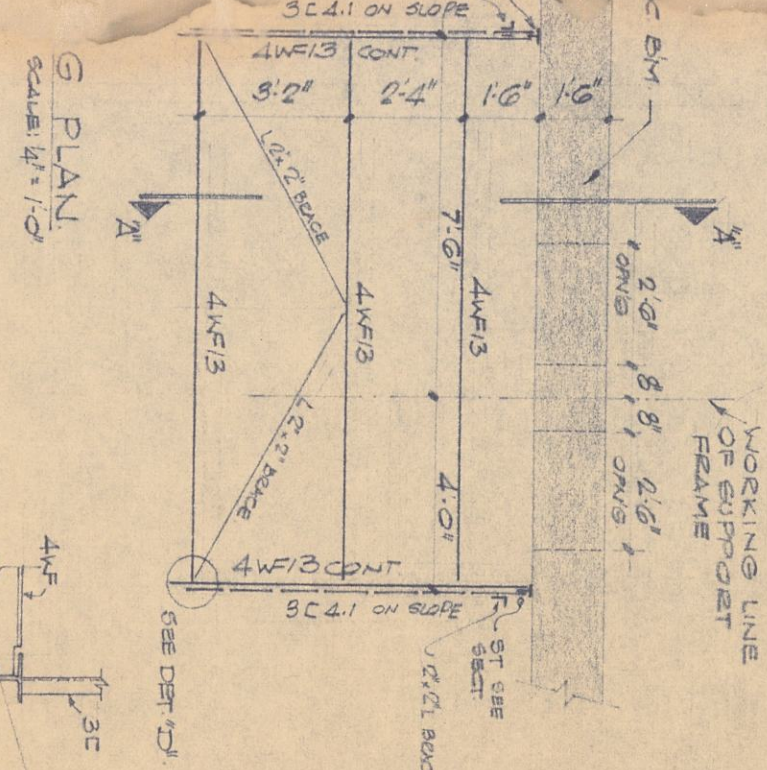

DETAIL 'D'

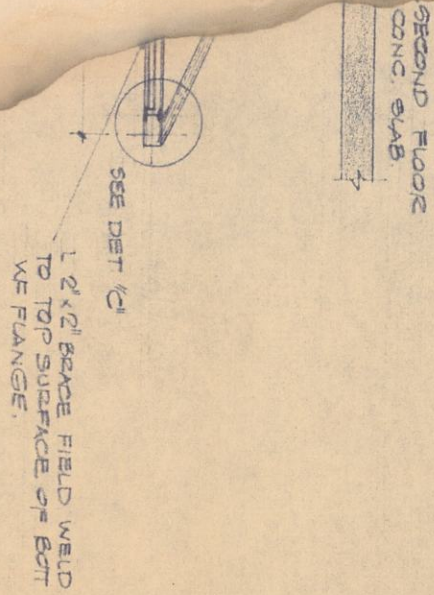

DETAIL 'C'

DETAIL 'C' SHOWS THE LOCATION OF THE REIN. STRIP IN THE SLAB. THE REIN. STRIP IS TO BE 1/2" O.C. IN THE TRANS. DIRECTION & TO BE 12" O.C. IN THE LONG. DIRECTION. (THIS REIN. NOT SHOWN ON REINFORCING PLANS) ALL BOTTOM STEEL SHOWN ON PLANS ARE CUT.

MACHINE ROOM ROOF FRAMING PLAN

TOP OF CONC. + 75.11'

SCALE: 1/4" = 1'-0"

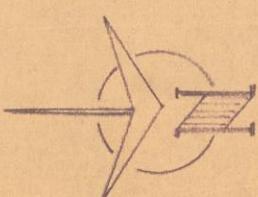
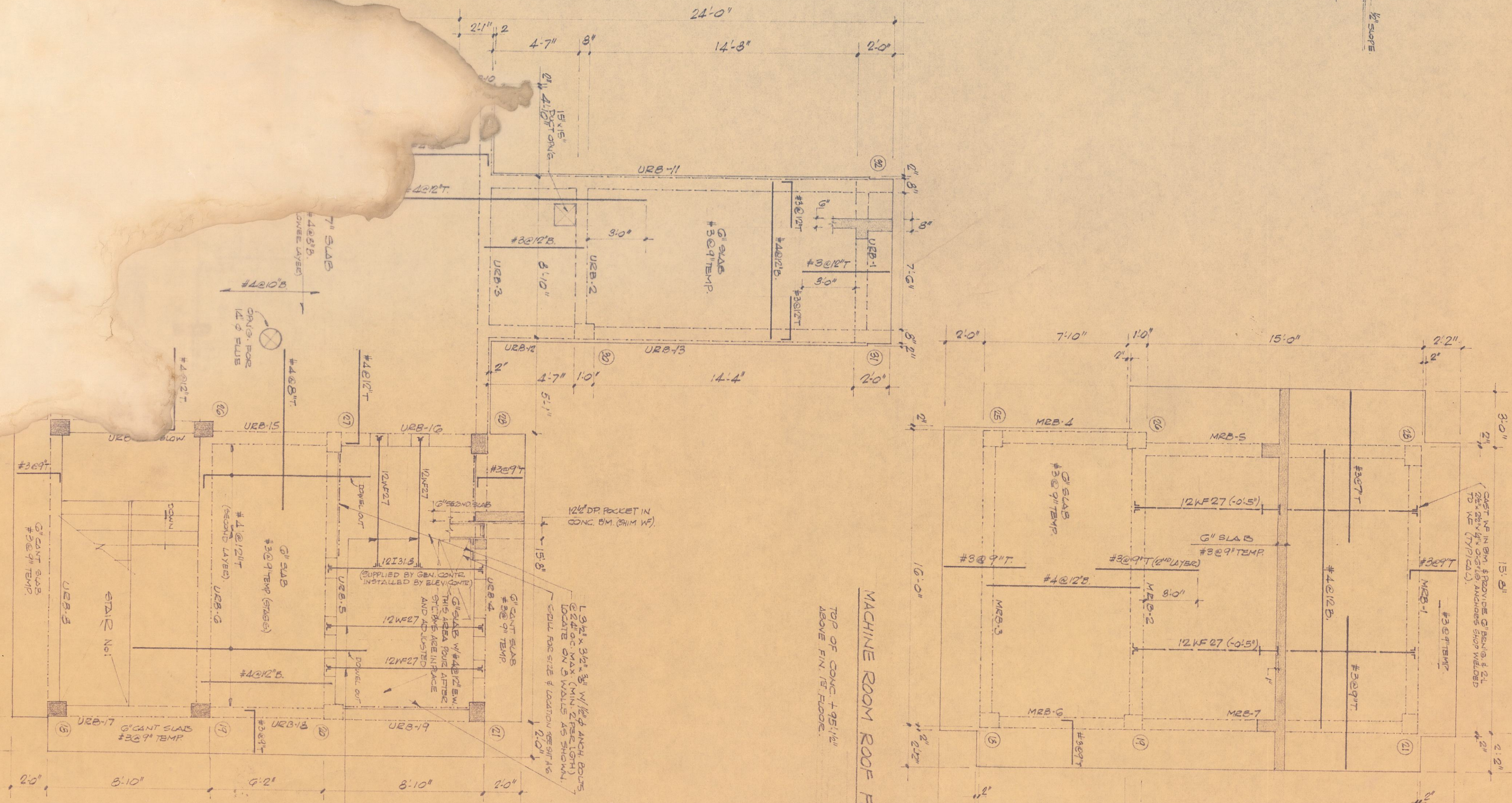

ROBERT M. SERRA, A.L.A.



UPPER DOOR & MACHINE ROOM ROOF FRAMING PLAN
SCALE: 1/4" = 1'-0"

REIFF ASSOCIATES DON REIFF • ARCHITECT
ARCHITECTS — ENGINEERS JOSEPH REIFF • ENGINEER
NORTH MIAMI BEACH, FLORIDA

THE ASHLEY CONDOMINIUM APT. BLDG.
3640 COLLING AVE. MIAMI BEACH, FLA.

3760
1-4-67
S-3

REV. 1-67 1/2" = 1'-0" SCALE FOR ALL VIEWS

DESIGNED BY
DRAWN BY
CHECKED BY